

Value1200EILCD/Value1500EILCD  
Value2200EILCD

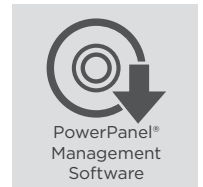

### IEC SOCKETS FOR PROFESSIONAL USAGES

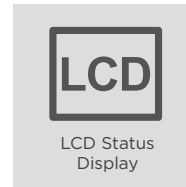
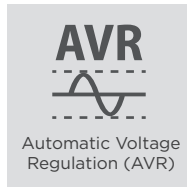
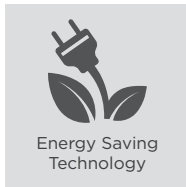
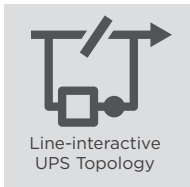

### The GreenPower UPS providing reliable power protection with built-in Automatic Voltage Regulation for home and office

Ideal for home, SOHO office, office and back office applications, the Value Series adopts line-interactive topology with Automatic Voltage Regulation (AVR) function to offer stabilized AC power output. This series features IEC sockets for connections with PCs, laptops, and printers, etc. The included RJ11/RJ45 port can provide data line protection against surge and spike. The products' power management software achieves real-time monitoring and configuration.

#### APPLICATION

- Home
- Office
- SOHO Office
- Back Office

#### SERIES FEATURES

- Line-interactive UPS Topology
- Automatic Voltage Regulation (AVR)
- Surge and Spike Protection
- LCD Status Display
- Tower Form Factor
- Energy Saving Technology
- Overload Protection
- Phone/Fax/Modem/DSL/Network Protection
- PowerPanel® Management Software

#### PRODUCT CALLOUTS

1. Power On Indicator
2. Power On/Off Switch
3. LCD Display Panel
4. Function Button(s)
5. Battery Backup & Surge Protected Outlets
6. Communication Protection Ports RJ11/RJ45
7. Input Circuit Breaker
8. AC Inlet
9. USB Port
10. Serial Port

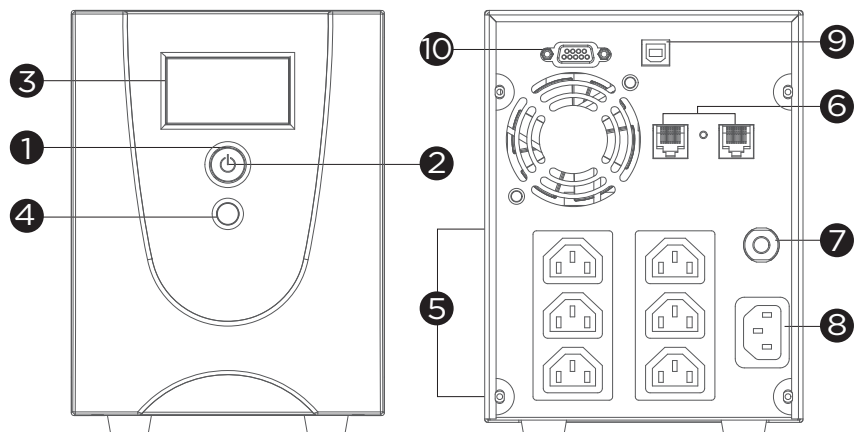

Value1200/1500/2200EILCD



## TECHNICAL SPECIFICATIONS

Model Name	Value1200EILCD	Value1500EILCD	Value2200EILCD
<b>General</b>			
UPS Topology	Line-interactive	Line-interactive	Line-interactive
Energy Saving Technology	GreenPower UPS™ Bypass Technology	GreenPower UPS™ Bypass Technology	GreenPower UPS™ Bypass Technology
<b>Input</b>			
Nominal Input Voltage (Vac)	230 ± 10%	230 ± 10%	230 ± 10%
Input Voltage Range (Vac)	165 - 280	165 - 280	165 - 280
Input Frequency (Hz)	50 ± 5, 60 ± 5	50 ± 5, 60 ± 5	50 ± 5, 60 ± 5
Input Frequency Detection	Auto-sensing	Auto-sensing	Auto-sensing
Rated Input Current (A)	5.45	6.82	10
Input Connector Type	IEC C14	IEC C14	IEC C14
<b>Output</b>			
Capacity (VA)	1200	1500	2200
Capacity (Watts)	720	900	1320
On Battery Waveform	Simulated Sine Wave	Simulated Sine Wave	Simulated Sine Wave
On Battery Voltage(s) (Vac)	230 ± 10%	230 ± 10%	230 ± 10%
On Battery Frequency (Hz)	50 ± 1%, 60 ± 1%	50 ± 1%, 60 ± 1%	50 ± 1%, 60 ± 1%
Automatic Voltage Regulation (AVR)	Single Boost, Single Buck	Single Boost, Single Buck	Single Boost, Single Buck
Overload Protection	Circuit Breaker	Circuit Breaker	Circuit Breaker
Outlet(s) - Total	6	6	6
Outlet Type	IEC C13 x 6	IEC C13 x 6	IEC C13 x 6
Outlet(s) - Battery & Surge Protected	6	6	6
Typical Transfer Time (ms)	4	4	4
<b>Battery</b>			
Runtime at Half Load (min)	8	10	7
Runtime at Full Load (min)	2	2	1
Typical Recharge Time (Hours)	8	8	8
User Replaceable	Yes	Yes	Yes
Battery Type	Sealed Lead-acid	Sealed Lead-acid	Sealed Lead-acid
Replacement Battery Pack	RBPO084	RBPO085	RBPO086
RBP Quantity (pcs)	2	2	2
<b>Surge Protection &amp; Filtering</b>			
Surge Suppression (Joules)	125	125	125
EMI/RFI Filtration	Yes	Yes	Yes
Phone/Network Protection RJ11/RJ45 (Combo)	1-in, 1-out	1-in, 1-out	1-in, 1-out
<b>Management &amp; Communications</b>			
LCD Panel	Yes	Yes	Yes
HID Compliant USB Port(s)	1	1	1
Serial Port	RS232	RS232	RS232
Audible Alarms	Battery Mode, Low Battery, Overload, Overcharge, UPS Fault		
Power Management Software	PowerPanel® Personal Edition	PowerPanel® Personal Edition	PowerPanel® Personal Edition
<b>Physical</b>			
Form Factor	Tower	Tower	Tower
<b>Physical Size - UPS Module</b>			
Dimensions (WxHxD) (mm.)	140 x 180 x 326	140 x 180 x 326	140 x 180 x 326
Weight (kg.)	11.2	13.2	14.5
<b>Environmental</b>			
Operating Temperature (°C)	0 - 40	0 - 40	0 - 40
Operating Relative Humidity (Non-condensing) (%)	0 - 90	0 - 90	0 - 90
Online Thermal Dissipation (BTU/hr)	167	198	225
<b>Certifications</b>			
Certifications*	CE, EAC	CE, EAC	CE, EAC
RoHS	Yes	Yes	Yes

\*Certifications may vary according to different regions. Visit [www.cyberpower.com](http://www.cyberpower.com) for more information.  
#All specifications are subject to change without notice.